

Address :
 Shop No. - 15/16, Pushpa Ganga CHS,
 Plot No - 04, Sector - 09, Kamothe,
 Navi Mumbai - 410 209

Contact :
 9833444863 / 8369904569
sales.kharghar@sambhavgroup.net
www.sambhavgroup.net

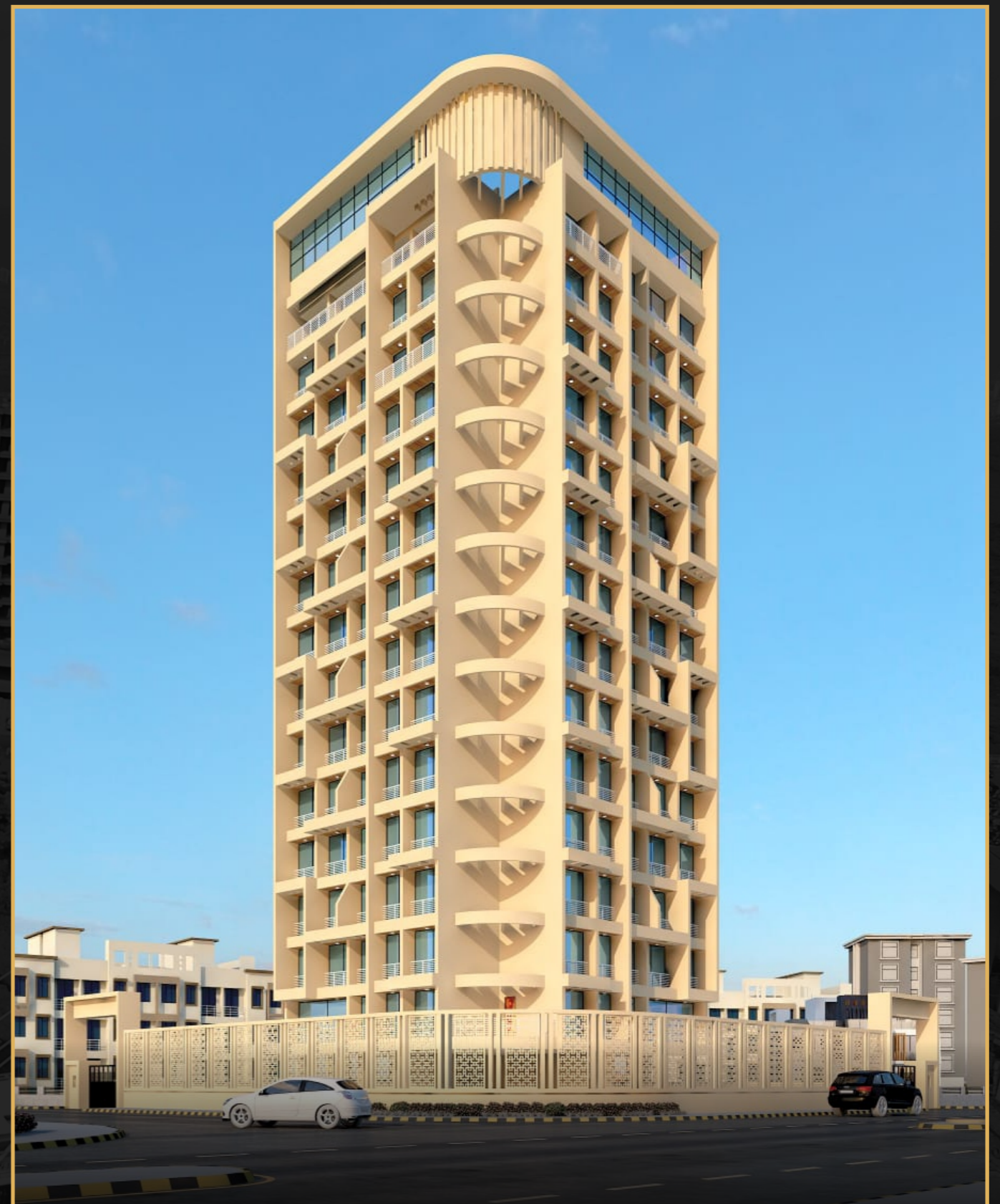

SAMBHAV GROUP™

DEEP VISIONAIRE

Plot No. 45/10, Sector - 34A, Kharghar - 410210

RERA No. - P52000019992
maharera.mahaonline.gov.in



SAMBHAV GROUP™

Everyone's dreams
"Sambhav" will turn into reality

Sambhav Group takes extreme pride on being one of the most trusted builders in Navi Mumbai. We believe in nurturing people dreams of having our own home and give them an opportunity to turn their dream into reality within their budget.

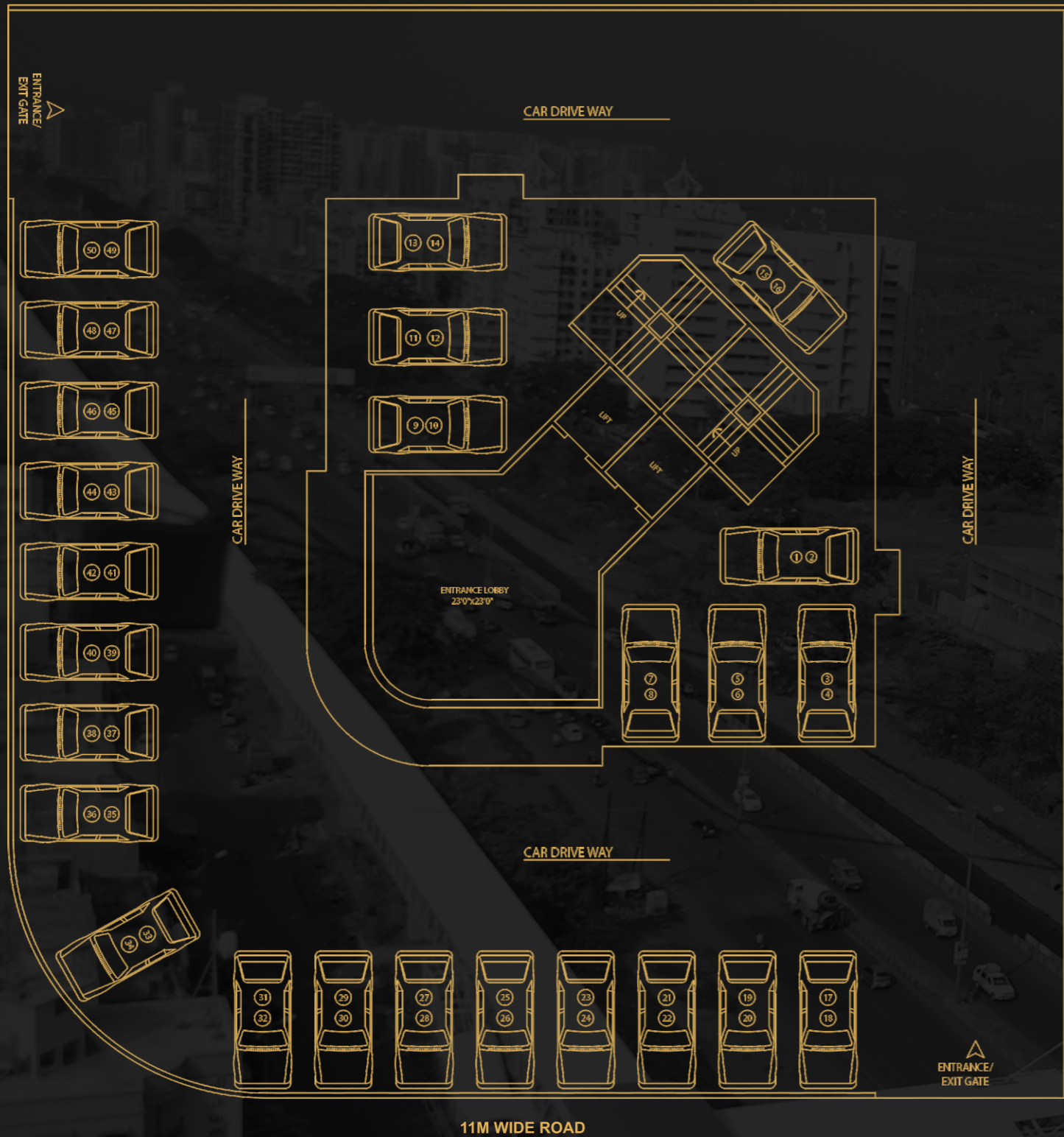

GROUND FLOOR



1ST FLOOR

11M WIDE ROAD



11M WIDE ROAD

2ND, 4TH, 6TH, 8TH FLOORS

11M WIDE ROAD

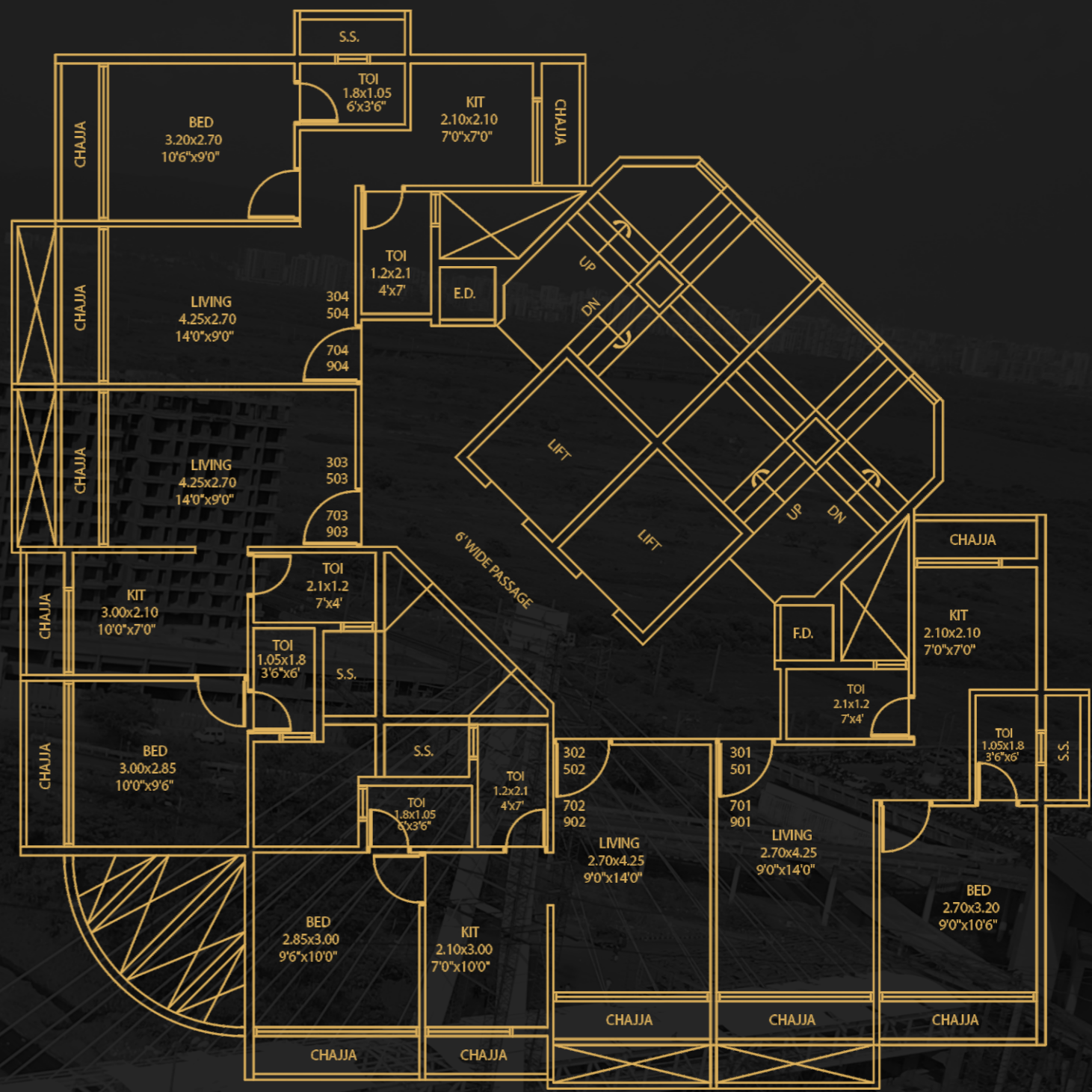

11M WIDE ROAD

3RD, 5TH, 7TH, 9TH FLOORS



10TH FLOOR

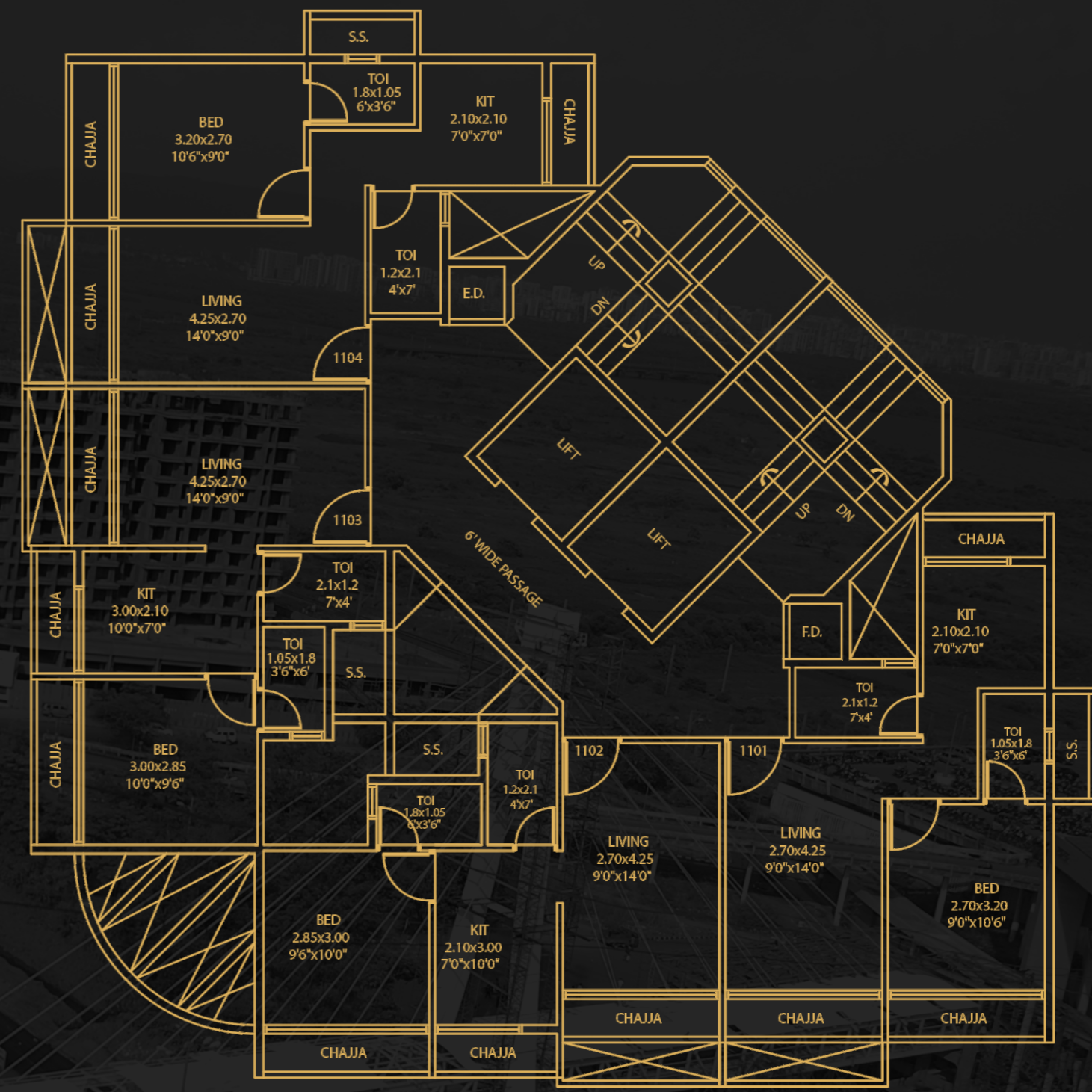

11TH FLOOR



12TH FLOOR



13TH FLOOR

PROJECT FEATURES

- CIDCO Allotted plot
- Ground + 14 Full residential building
- Exclusive 1BHK, 1BHK Terrace and 2BHK Terrace Flat
- Terrace Flat available
- Lifts of reputed make
- Car Parking space on Ground floor



14TH FLOOR

"A New Beginning for a New Life Style"



SAMBHAV GROUP™

AMENITIES

	<ul style="list-style-type: none">• 2' X 2' vitrified tiles flooring in entire Flat.
	<ul style="list-style-type: none">• Designer Main Door with elegant fittings.• Laminate flush door for bedroom.• Bakelite doors for all bath & W.C.
	<ul style="list-style-type: none">• Granite Platform with stainless steel sink and ceramic tiles dado above counter upto 7' height.
	<ul style="list-style-type: none">• Wall putty finished walls with acrylic distemper paint in entire flat.• Acrylic paint on external walls.
	<ul style="list-style-type: none">• Powder coated aluminum sliding window with marble sill.

AMENITIES

	<ul style="list-style-type: none">• Sufficient electric points with ISI marked switch in all rooms.• Provision for cable T.V/Telephone connection in living room & master bedroom.• ISI marked concealed copper wiring with MCB/ELCB.
	<ul style="list-style-type: none">• Good Quality toilets with marble window sill and door frame.• Tiles dado upto 7' height.• Concealed plumbing.• Quality CP & Sanitary fittings of reputed make.
	<ul style="list-style-type: none">• Underground and overhead water tank with adequate storage capacity.
	<ul style="list-style-type: none">• Special water proofing treatment with china chips flooring.
	<ul style="list-style-type: none">• Garden, Gym, Indoor Games on 1st Floor.